

### ➤ General Description

This PAP2023ES Dual P-Channel enhancement mode power field effect transistor is the high density trench technology and this advanced technology can provide excellent  $R_{ds(On)}$  performance and efficiency for power switching and load switching application., this device also comply with the RoHS and Green Product requirement with full function reliability approved.

### ➤ Feature

- Super high density cell design for extremely low  $R_{DS(ON)}$
- Exceptional on-resistance and maximum DC current capability
- ESD Protected
- DFN2X2-6L package design

### ➤ Application

- Charger Switches and Load Switches for Portable Devices
- DC/DC Converters

### ➤ DFN2X2-6L

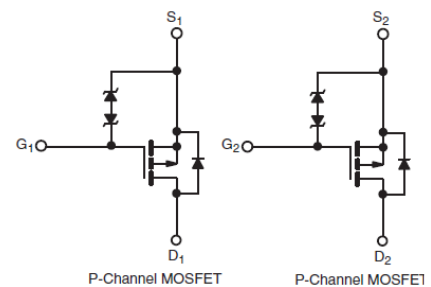
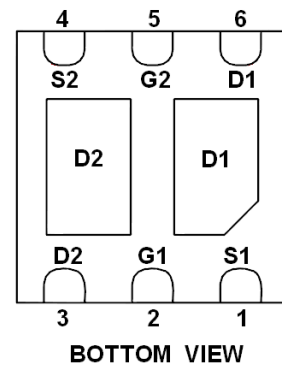

### ➤ Absolute Maximum Ratings

Parameter	Symbol	Rating	Unit
Drain-Source Voltage	$V_{DSS}$	-20	V
Gate -Source Voltage	$V_{GSS}$	$\pm 12$	V
Continuous Drain Current( $T_J=150^\circ C$ )	$I_D$	$T_C=25^\circ C$	-4.5
		$T_C=70^\circ C$	-4.5
Pulsed Drain Current	$I_{DM}$	-20	A
Continuous Source Current(Diode Conduction)	$I_S$	-1.6	A
Power Dissipation	$P_D$	$T_C=25^\circ C$	7.8
		$T_C=70^\circ C$	5.0
Operating Junction Temperature	$T_J$	150	$^\circ C$
Storage Temperature Range	$T_{STG}$	-55/150	$^\circ C$
Thermal Resistance-Junction to Ambient	$R_{\theta JA}$	52	$^\circ C/W$
Thermal Resistance-Junction to Case(Drian)	$R_{\theta JC}$	12.5	

#### ➤ Electrical Characteristics ( $T_A=25^\circ C$ Unless otherwise noted)

Parameter	Symbol	Conditions	Min.	Typ	Max.	Unit
<b>Static</b>						
Drain-Source Breakdown Voltage	$V_{(BR)DSS}$	$V_{GS}=0V, I_D=-250\mu A$	-20			V
Gate Threshold Voltage	$V_{GS(th)}$	$V_{DS}=V_{GS}, I_D=-250\mu A$	-0.4		-1.0	
Gate Leakage Current	$I_{GSS}$	$V_{DS}=0V, V_{GS}=\pm 8V$			$\pm 10$	$\mu A$
Zero Gate Voltage Drain Current	$I_{DSS}$	$V_{DS}=-16V, V_{GS}=0V$			-1	$\mu A$
		$V_{DS}=-16V, V_{GS}=0V$ $T_J=85^\circ C$			-10	
On-State Drain Current	$I_{D(on)}$	$V_{DS} \geq -5V, V_{GS}=-4.5V$	-10			A
Drain-Source On-Resistance	$R_{DS(on)}$	$V_{GS}=-4.5V, I_D=-4.5A$		37	42	$m\Omega$
		$V_{GS}=-2.5V, I_D=-3.4A$		46	52	
		$V_{GS}=-1.8V, I_D=-2.4A$		59	68	
Forward Transconductance	$g_{FS}$	$V_{DS}=-6V, I_D=-4.6A$		12		S
Diode Forward Voltage	$V_{SD}$	$I_S=-1.25A, V_{GS}=0V$		-0.85	-1.2	V
<b>Dynamic</b>						
Total Gate Charge	$Q_g$	$V_{DS}=-6V, V_{GS}=-4.5V$ $I_D=-5.6A$		10	18	nC
Gate-Source Charge	$Q_{gs}$			2.5		
Gate-Drain Charge	$Q_{gd}$			2.8		
Input Capacitance	$C_{iss}$	$V_{DS}=-6V, V_{GS}=0V$ $f=1MHz$		1450		pF
Output Capacitance	$C_{oss}$			265		
Reverse Transfer Capacitance	$C_{rss}$			255		
Turn-On Time	$t_{d(on)}$	$V_{DD}=-10V, R_L=2.7\Omega$ $I_D=-3.7A, V_{GEN}=-4.5V$ $R_G=1\Omega$		15	25	ns
	$t_r$			25	40	
Turn-Off Time	$t_{d(off)}$			40	65	
	$t_f$			15	25	

### ➤ Typical Characteristics

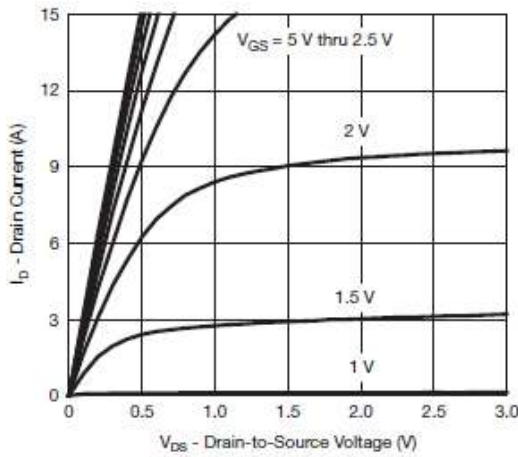

Output Characteristics

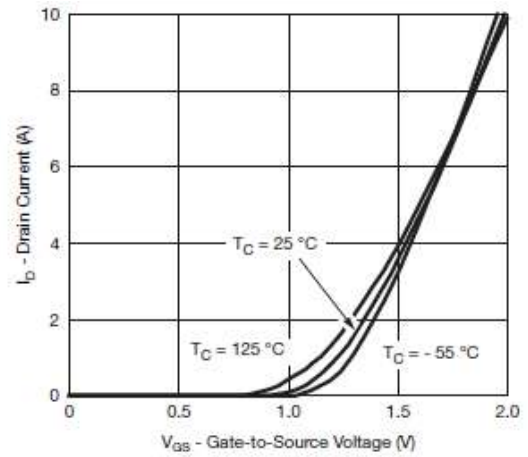

Transfer Characteristics

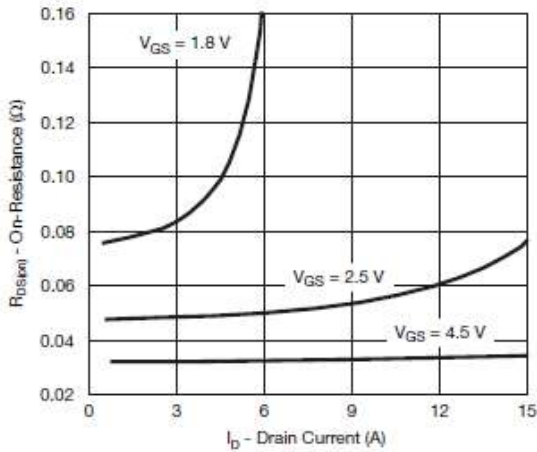

On-Resistance vs. Drain Current and Gate Voltage

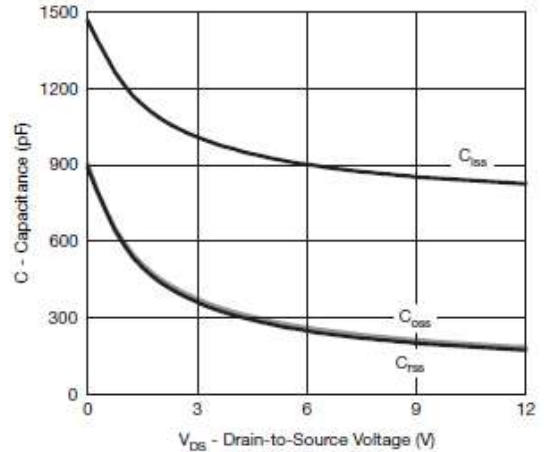

Capacitance

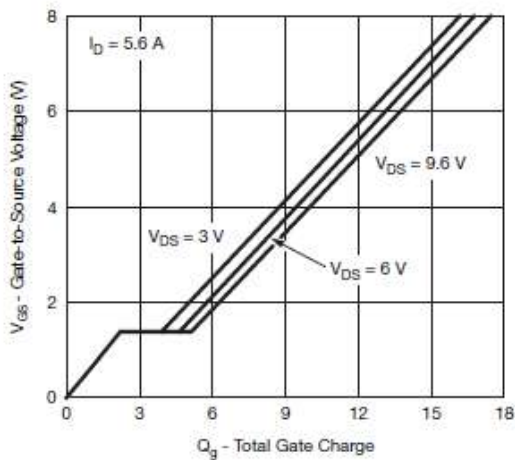

Gate Charge

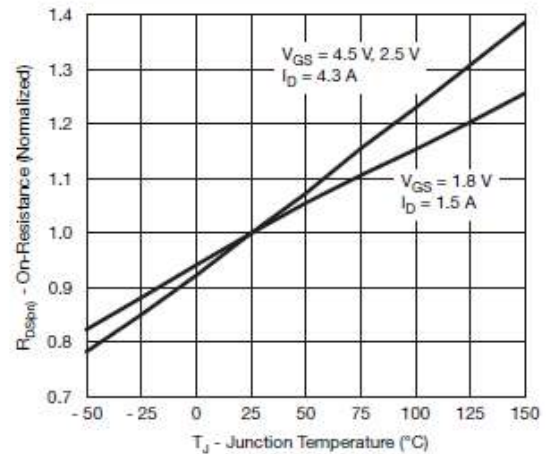

On-Resistance vs. Junction Temperature

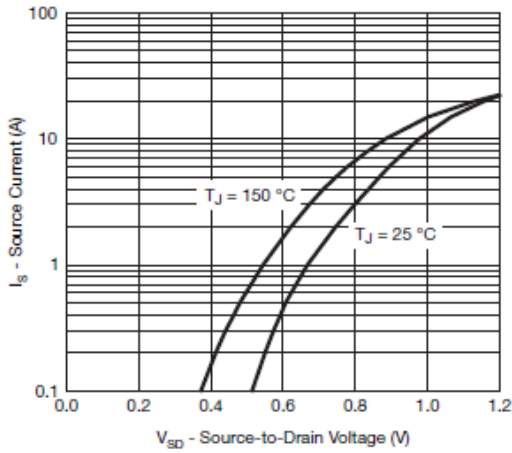

Source-Drain Diode Forward Voltage

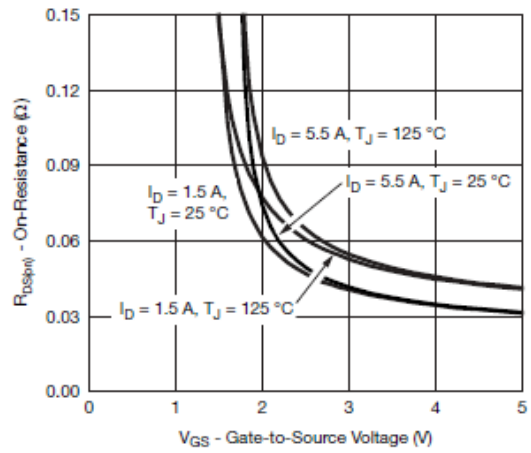

On-Resistance vs. Gate-to-Source Voltage

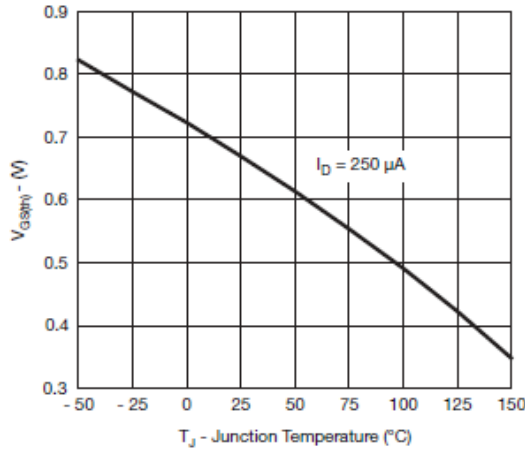

Threshold Voltage

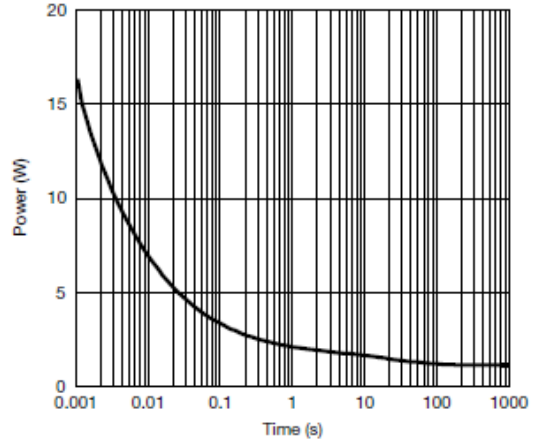

Single Pulse Power, Junction-to-Ambient

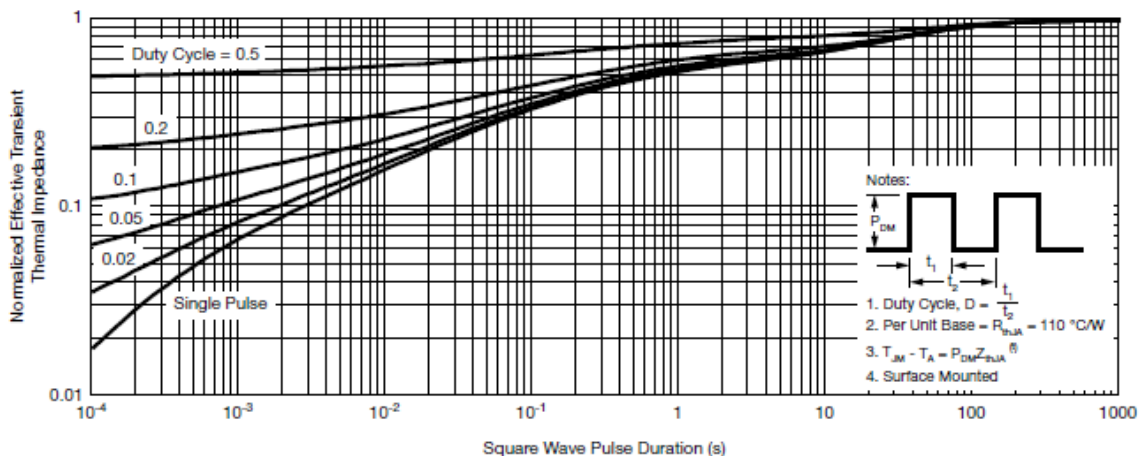

Normalized Thermal Transient Impedance, Junction-to-Ambient

### ➤ Recommnd IR Reflow Soldering Thermal Profile



Profile Feature	Pb-Free Assembly Profile
Temperature Min. (T <sub>smin</sub> )	150°C
Temperature Max. (T <sub>smax</sub> )	200°C
Time (t <sub>s</sub> ) from (T <sub>smin</sub> to T <sub>smax</sub> )	60-120 seconds
Average Ramp-up Rate (t <sub>L</sub> to t <sub>P</sub> )	3°C/second max.
Liquidous Temperature (T <sub>L</sub> )	217°C
Time (t <sub>L</sub> ) Maintained Above (T <sub>L</sub> )	60 – 150 seconds
Peak Temperature	260°C +0°C / -5°C
Time (t <sub>P</sub> ) within 5°C of actual Peak Temperature	30 seconds
Ramp-down Rate (T <sub>P</sub> to T <sub>L</sub> )	6°C/second max
Time 25°C to Peak Temperature	8 minutes max.

### ➤ Ordering Information

Part Number	Description	Quantity
PAP2023ES	DFN2X2-6L Reel	4000 pcs

### ➤ Package Information (DFN2X2-6L)

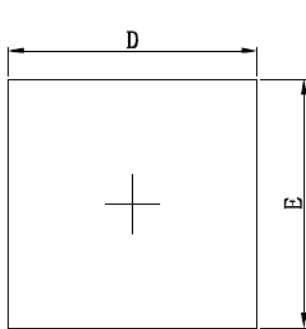

**Top View**

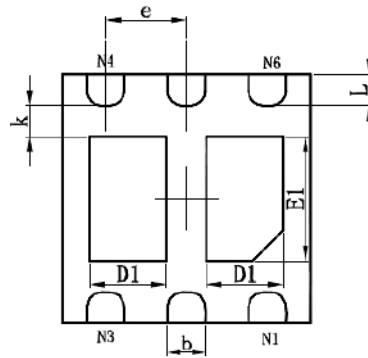

**Bottom View**

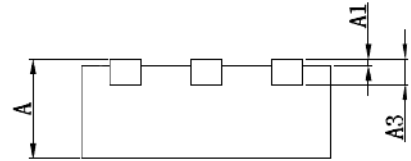

**Side View**

Symbol	Dimensions In Millimeters		Dimensions In Inches	
	Min.	Max.	Min.	Max.
A	0.700/0.800	0.800/0.900	0.028/0.031	0.031/0.035
A1	0.000	0.050	0.000	0.002
A3	0.203REF.		0.008REF.	
D	1.924	2.076	0.076	0.082
E	1.924	2.076	0.076	0.082
D1	0.520	0.720	0.020	0.028
E1	0.900	1.100	0.035	0.043
k	0.200MIN.		0.008MIN.	
b	0.250	0.350	0.010	0.014
e	0.650TYP.		0.026TYP.	
L	0.174	0.326	0.007	0.013

## DISCLAIMER

- The information in this document and any product described herein are subject to change without notice and should not be construed as a commitment by Paceleader, Paceleader reserve the right to make changes to the information in this document.
- Though Paceleader make effort to improve product quality and reliability, Product can malfunction and fail due to their inherent electrical sensitivity and vulnerability to physical stress, it is the responsibility of the customer, when utilizing Paceleader products, to comply with the standards of safety in making a safe design for entire system and to avoid situation in which a malfunction or failure., In developing a new designs, customer should ensure that the device which shown in this documents are used within specified operatingranges.
- The information contained herein is presented only as a guide for the applications of our products. No responsibility is assumed by Paceleader for any infringements of patents or other rights of the third parties which may result from its use.